

DELTA SYSTEM 



adaptable-custom solutions!

During the design process for Delta, we interviewed broadcast engineers, systems integrators, and installers to determine the finite requirements and a wish list of a truly, modular console system. We took apart competitive offerings to glean strengths and weaknesses. As our concept developed, we evaluated our manufacturing processes and tested and refined our material selections. We are confident; the net result is an adaptable solution that is second to none.

CBS- Entertainment Tonight-

The Delta base is a welded, tubular steel frame provides a rigid platform for the two structural, aluminum extrusions and a shelf for the steel cable basket. It also has 10 Units of front rail and optional rear rail. A continuous rear channel captures the bottom of our lift off rear access panels. The base module is available in a single, double, triple or quad bay configuration. Modules bolt together quickly. Heavy gauge steel gusset plates facilitate either a caster or fastener to floor. There is no assembly required. The aluminum extrusions are milled to accept standard 5/16" carriage bolts without having to access the end of the channel. Monitor Arms, Lights, Speaker stands, and Phone rests easily attach to the extrusion and can be easily moved.

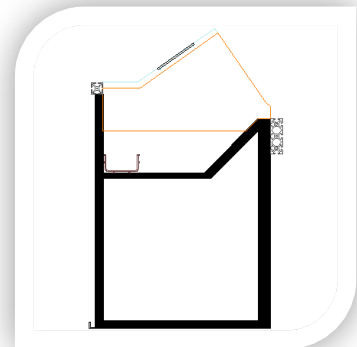

Now we are ready to select and add the equipment turrets or blanks to the console module. Some examples of our turrets are:

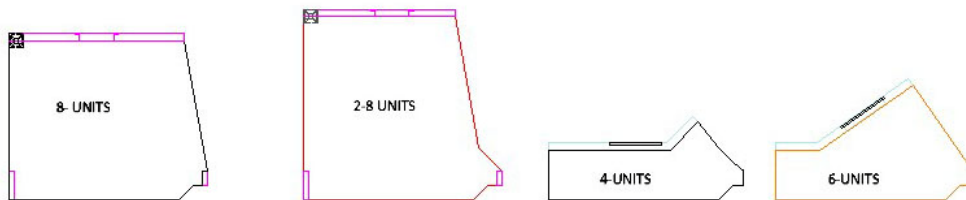

The turrets can be located anywhere along the base module(s) and are simply attached with 4 bolts.

DELTA SYSTEM 

This console is set up with 4-Unit Turrets and plugs for telephones and to add additional surface area for the workstations. At this point, some integrators prefer to secure their equipment with unfettered access, before the console surfaces are installed. **Rack turrets are easily replaceable by your facilities personnel.**



Cantilevers are placed where needed and can slide along the main extrusion for future cut outs in the console surface. We offer a variety of end panel shapes as well which are available in any finish combination. For example, with this one on the left, the console becomes “freestanding”. We are ready to install the console surfaces which we offer in an almost unlimited choice of materials and premium edge profiles.

We can easily customize a base module for a specific production switcher, aux. panel and ancillary gear.



NBC-UNIVERSAL -Burbank

Wide choices of finishes are available; choose laminates from Formica, Wilsonart, Nevamar; solid surface materials from Corian, Meganite, Avonite, Staron; or certified exotic hardwoods. Construction: Our console tops feature either a cold-pressed glued composite material with a balanced laminate and a finish thickness of 1-1/4 inches, or choose solid-surface material throughout.

Our rear access are made with incredibly durable ABS “playground” plastic and are secured with marine grade, compression latches.

DELTA SYSTEM 

Applications:

Broadcast

- Production Control
- Audio Control
- Master Control
- Technical Operations Centers
- Mobile Production Vehicles
- Command and Control
- Network Operations Centers
- Security
- Military-

Hybrids:

We have also incorporated the Delta System rail into some of our Post Production and Ready to Assemble Furniture. Again the rail adds flexibility for perfect positioning of monitors and lighting. We can customize a design to work for almost any application. We can also fabricate custom display supports and motorized systems to integrate with our furniture.



Recent DELTA Projects:

The Jay Leno Show	The George Lopez Show
City Of Huntington Beach	CNN- Los Angeles
Trinity Broadcasting	United States Air Force
WBBM- Chicago	Los Angeles Police Department
The Church Of Ladder Saints-	Los Angeles Dodgers
Entertainment Tonight	Associated Press

Laguna Designs Inc.

1060 Ortega Way, Unit "C", Placentia, CA. 92870

Toll Free- (877) 649-6720

Laguna Designs Inc.

Technical millwork for Broadcast and Post